

## MEETINGS AT LONDONHOUSE

With 10 flexible meeting spaces and 4 private dining spaces offering up to 25,000 sq. ft. of catering and event space. LondonHouse Chicago offers the ideal venue for business meetings, conferences and social gatherings of almost any size.

### CONCOURSE LEVEL

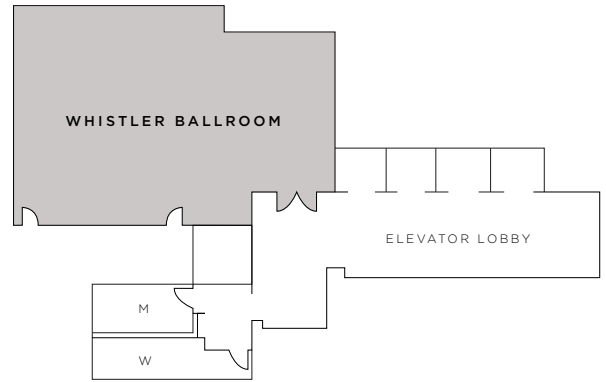

### LEVEL THREE

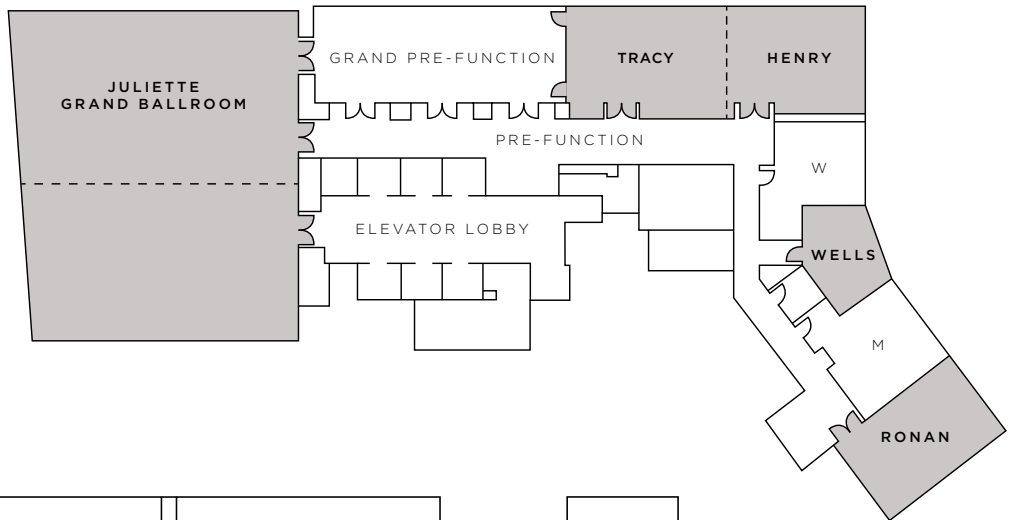

### LEVEL FIVE

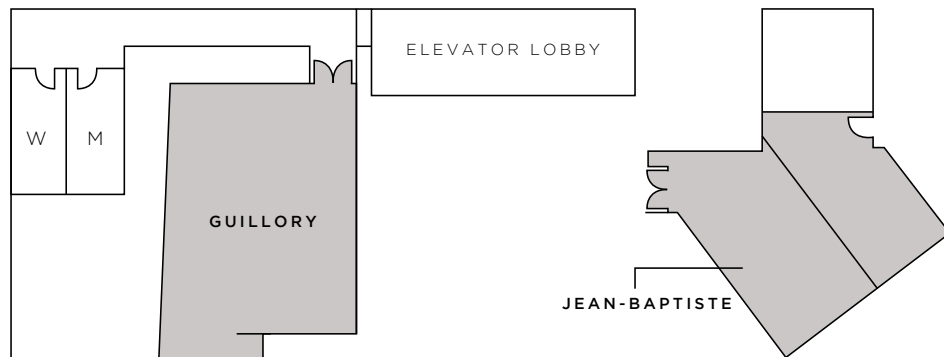

**LEVEL SIX**

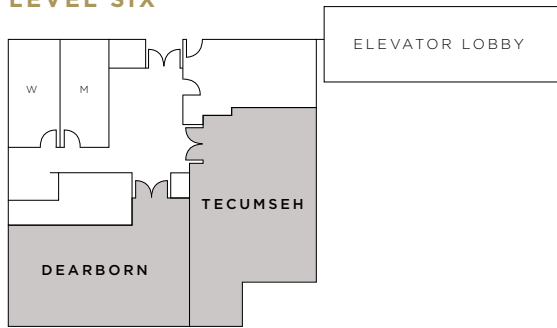

**LEVEL TWENTY-ONE  
PRIVATE DINING SPACE**

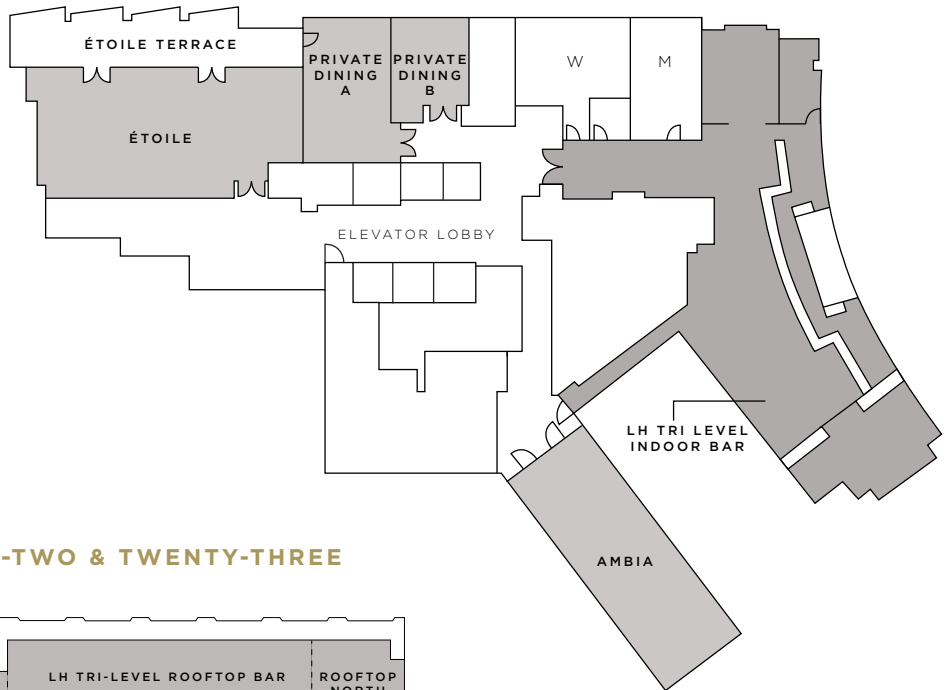

**LEVELS TWENTY-TWO & TWENTY-THREE  
ROOFTOP SPACE**

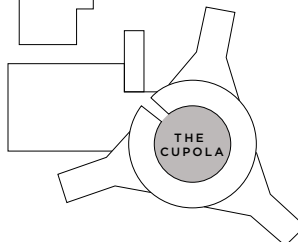
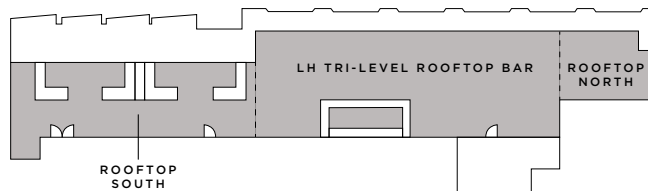

**LONDONHOUSE**  
CHICAGO

## SPACE DIMENSIONS

### CONCOURSE LEVEL MEETING SPACE

ROOM	SQUARE FOOTAGE	ROUNDS OF TEN	CLASSROOM	THEATRE	EXHIBIT	CONFERENCE	U-SHAPE	RECEPTION	CEILING HEIGHT
WHISTLER BALLROOM	2171	120	104	130	11	66	60	200	10'3"
PRE-FUNCTION	382	—	—	—	—	—	—	50	—

### LEVEL THREE MEETING SPACE

ROOM	SQUARE FOOTAGE	ROUNDS OF TEN	CLASSROOM	THEATRE	EXHIBIT	CONFERENCE	U-SHAPE	RECEPTION	CEILING HEIGHT
JULIETTE GRAND BALLROOM	3737	270	204	285	18	113	92	350	17'
JULIETTE A	1865	130	90	140	8	46	45	175	17'
JULIETTE B	1862	140	110	155	8	55	45	175	17'
GRAND PRE-FUNCTION	900	—	—	—	—	—	—	100	—
TRACY	669	50	30	52	—	30	27	60	8'6"
HENRY	524	30	24	32	—	24	21	50	8'6"
TRACY/HENRY	1193	80	64	84	—	56	—	110	8'6"
RONAN	516	40	24	32	—	24	24	50	8'6"
WELLS BOARDROOM	281	—	—	—	—	8	—	—	8'6"
PRE-FUNCTION	934	—	—	—	—	—	—	120	—

### LEVEL FIVE MEETING SPACE

ROOM	SQUARE FOOTAGE	ROUNDS OF TEN	CLASSROOM	THEATRE	EXHIBIT	CONFERENCE	U-SHAPE	RECEPTION	CEILING HEIGHT
GUILLORY	1369	80	70	90	—	36	35	120	8'6"
JEAN-BAPTISTE	592	40	24	40	—	24	21	55	8'6"

### LEVEL SIX MEETING SPACE

ROOM	SQUARE FOOTAGE	ROUNDS OF TEN	CLASSROOM	THEATRE	EXHIBIT	CONFERENCE	U-SHAPE	RECEPTION	CEILING HEIGHT
DEARBORN	754	40	33	42	—	30	27	70	8'6"
TECUMSEH	621	60	30	56	—	30	27	60	8'6"
PRE-FUNCTION	443	40	—	—	—	—	—	50	—

### PRIVATE DINING

#### TWENTY-ONE & TWENTY-TWO & TWENTY-THREE

FLOOR	ROOM	SQUARE FOOTAGE	ROUNDS OF TEN	CLASSROOM	THEATRE	EXHIBIT	CONFERENCE	U-SHAPE	RECEPTION	CEILING HEIGHT
21	ÉTOILE	1346	80	36	80	—	34	32	130	10'
21	ÉTOILE TERRACE	560	—	—	—	—	—	—	50	—
21	AMBIA	1000	80	60	80	—	40	30	130	9'6"
21	PRIVATE DINING A	464	30	—	—	—	—	—	40	8'6"
21	PRIVATE DINING B	295	20	—	—	—	—	—	25	8'6"
22	LH ROOFTOP BAR	3536	—	—	—	—	—	—	200	—
22	ROOFTOP NORTH	360	—	—	—	—	—	—	25	—
22	ROOFTOP SOUTH	918	—	—	—	—	—	—	50	—
23	THE CUPOLA	237	10	—	—	—	—	—	30	—