



THE PERFECT BEGINNING

IT STARTS HERE



LONDONHOUSE
CHICAGO

EVENTS AT LONDONHOUSE

With 13 flexible meeting spaces offering up to 25,000 sq. ft. of catering and event space, LondonHouse Chicago offers the ideal venue.

CONCOURSE LEVEL

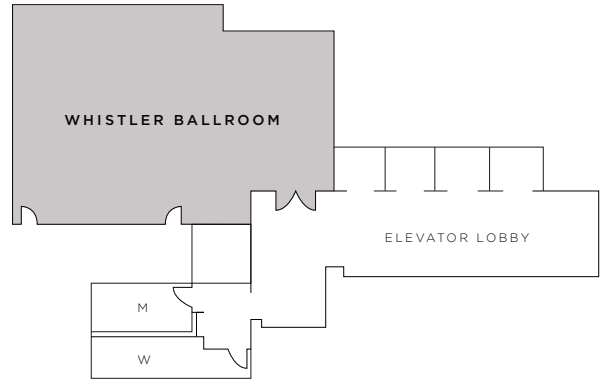

LEVEL THREE

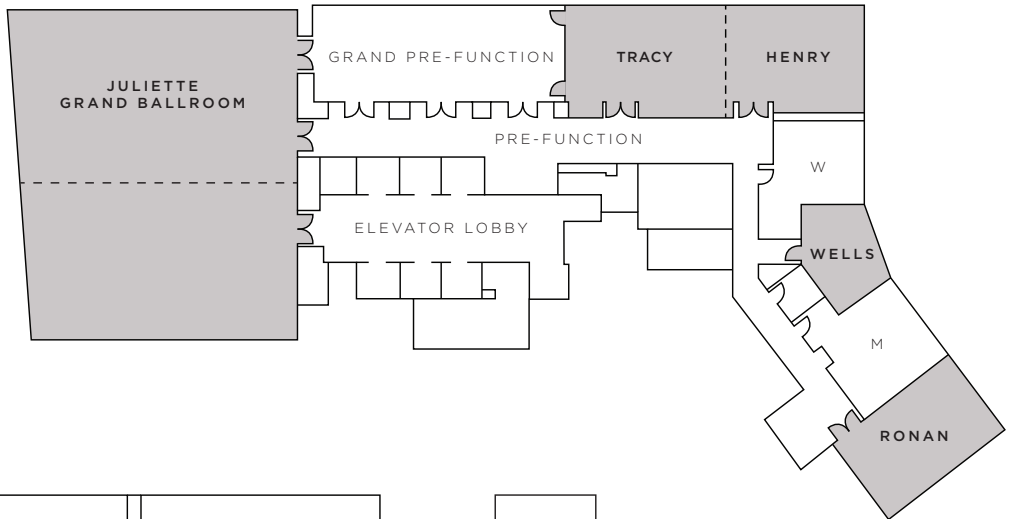

LEVEL FIVE

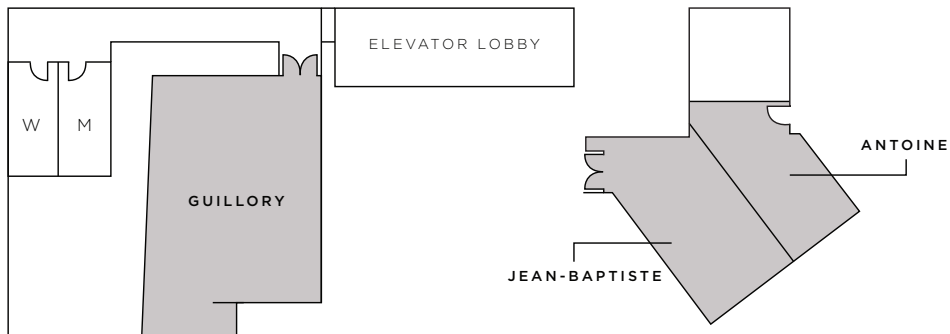

LEVEL SIX

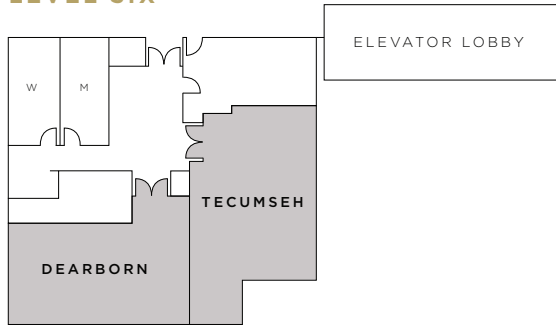

LEVEL TWENTY-ONE

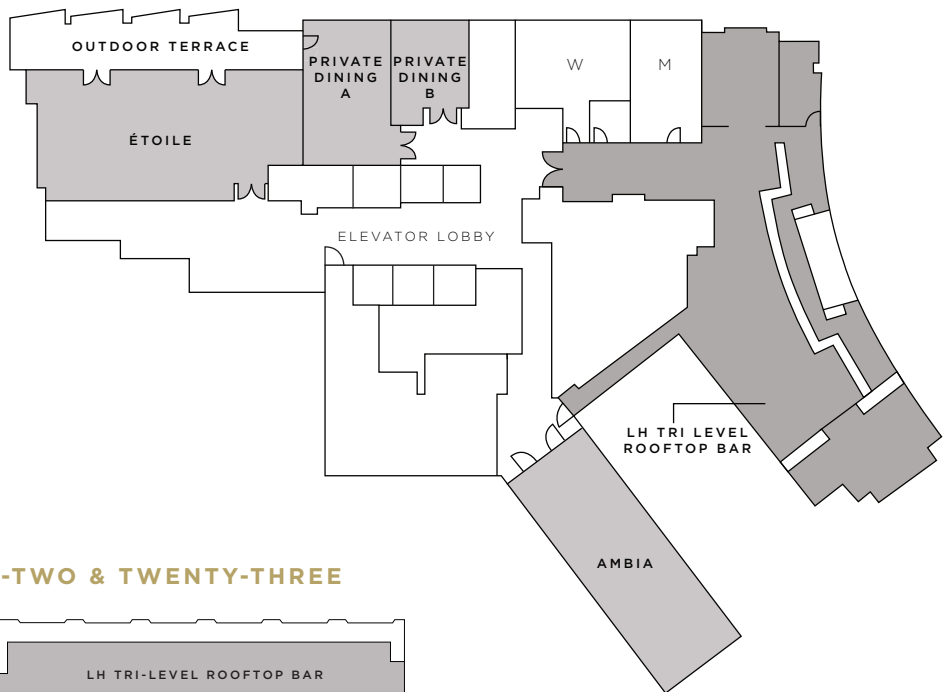

LEVELS TWENTY-TWO & TWENTY-THREE

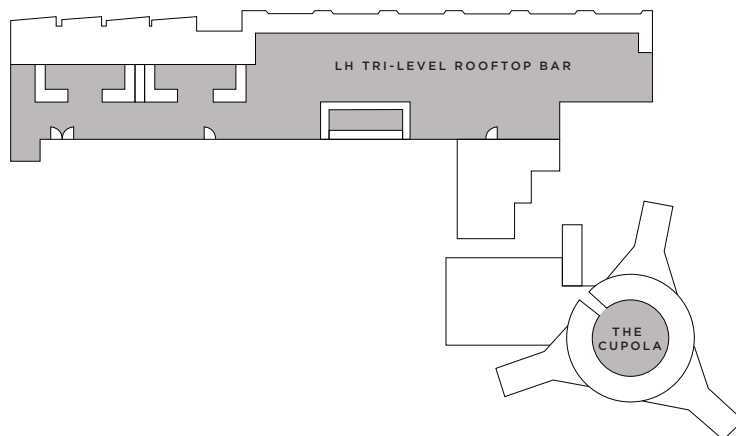

LONDONHOUSE
CHICAGO

MEETING SPACE DIMENSIONS

CONCOURSE LEVEL

ROOM	SQUARE FOOTAGE	ROUNDS OF TEN	CLASSROOM	THEATRE	EXHIBIT	CONFERENCE	U-SHAPE	RECEPTION	CEILING HEIGHT
WHISTLER BALLROOM	2171	180	120	215	11	—	—	300	10'3"
PRE-FUNCTION	382	—	—	—	—	—	—	50	—

LEVEL THREE

ROOM	SQUARE FOOTAGE	ROUNDS OF TEN	CLASSROOM	THEATRE	EXHIBIT	CONFERENCE	U-SHAPE	RECEPTION	CEILING HEIGHT
JULIETTE GRAND BALLROOM	3737	300	200	350	18	—	—	500	17'
JULIETTE A	1865	150	90	175	8	70	60	250	17'
JULIETTE B	1862	150	90	175	8	70	60	250	17'
GRAND PRE-FUNCTION	900	—	—	—	—	—	—	100	—
TRACY	669	60	40	60	—	20	20	80	8'6"
HENRY	524	40	30	50	—	20	17	70	8'6"
TRACY/WHENRY	1193	100	70	110	—	40	40	150	8'6"
RONAN	516	40	30	50	—	20	17	70	8'6"
WELLS BOARDROOM	281	—	—	—	—	8	—	—	8'6"
PRE-FUNCTION	934	—	—	—	—	—	—	120	—

LEVEL FIVE

ROOM	SQUARE FOOTAGE	ROUNDS OF TEN	CLASSROOM	THEATRE	EXHIBIT	CONFERENCE	U-SHAPE	RECEPTION	CEILING HEIGHT
GUILLORY	1369	100	70	130	—	50	45	150	8'6"
JEAN-BAPTISTE	592	50	30	60	—	20	18	70	8'6"
ANTOINE	383	30	20	40	—	15	12	50	8'6"

LEVEL SIX

ROOM	SQUARE FOOTAGE	ROUNDS OF TEN	CLASSROOM	THEATRE	EXHIBIT	CONFERENCE	U-SHAPE	RECEPTION	CEILING HEIGHT
DEARBORN	754	60	40	75	—	30	25	90	8'6"
TECUMSEH	621	50	30	60	—	20	18	80	8'6"
PRE-FUNCTION	443	40	—	—	—	—	—	50	—

LEVELS TWENTY-ONE & TWENTY-THREE

ROOM	SQUARE FOOTAGE	ROUNDS OF TEN	CLASSROOM	THEATRE	EXHIBIT	CONFERENCE	U-SHAPE	RECEPTION	CEILING HEIGHT
ÉTOILE	1346	100	70	130	—	50	44	150	10'
OUTDOOR TERRACE	560	—	—	—	—	—	—	75	—
AMBIA	1000	80	60	100	—	40	30	130	9'6"
PRIVATE DINING A	464	30	—	—	—	—	—	50	8'6"
PRIVATE DINING B	295	20	—	—	—	—	—	40	8'6"
THE CUPOLA	237	10	—	—	—	—	—	15	—

WHERE IT ALL COMES TOGETHER

It starts here at North Michigan Avenue and Wacker Drive – where Chicago grew up and your life together begins. LondonHouse Chicago is part of Curio- A Collection by Hilton™ and is Chicago's most unique luxury lifestyle hotel, offering planners and their clients one of the city's most unforgettable wedding venues.

Our array of incomparable options include the stunning Juliette grand ballroom, with floor to ceiling windows overlooking the Chicago River, the more intimately sized but equally stylish Whistler ballroom, Étoile, our 21st floor social event space with an open-air terrace and spectacular skyline views, and the stunning rooftop cupola offering one-of-a-kind vista of the skyline and Chicago's Magnificent Mile. LondonHouse Chicago offers a variety of flexible spaces perfect for wedding parties large and small.

We can even help you can take your pre-ceremony and post-reception festivities to a whole new level at LH, Chicago's only tri-level rooftop offering a unique indoor and outdoor dining experience, reimagined American cuisine and a variety of specialty drinks.

With 452 well-appointed and graciously-sized guest rooms and suites, 25,000 square feet of catering, social, and event space, plus incredible skyline views from virtually every window, LondonHouse Chicago stands proud, ready to help you celebrate where it all starts.

BOOK YOUR WEDDING TODAY- SALES@LONDONHOUSE.COM | 312.357.1200



Located on Michigan Avenue and Wacker Drive in the heart of Chicago, LondonHouse puts the city at your fingertips. Whether it be dining, theater, shopping or celebrating with friends and family, LondonHouse Chicago puts you in the perfect location to sample all the things that make Chicago great.



BOOK YOUR WEDDING TODAY - SALES@LONDONHOUSE.COM | 312.357.1200



LONDONHOUSE
C H I C A G O

85 EAST WACKER DRIVE AT NORTH MICHIGAN AVENUE | CHICAGO | ILLINOIS 60601
T 312 357 1200 | F 312 357 1288 | LONDONHOUSECHICAGO.COM

CURIO
A COLLECTION BY HILTON™

HILTON
HONORS